

Napo AGM 2023
Thurs 19 – Sat 21 Oct
Online or in person

**East Midlands
Conference Centre
Nottingham**



Napo AGM 2023

14.00hrs Thursday 19th October to
13.00hrs Saturday 21st October
**East Midlands Conference Centre
(EMCC) Nottingham**

**Welcome back to an in-person
AGM and to Napo's third hybrid
conference, streaming live from
Nottingham.**

Entrance to the AGM is through the
main entrance to the EMCC – the Napo
Reception and Stewards Information
desk will be in the Entrance Foyer.

All areas will be signposted, and
stewards will be on hand to assist and
direct. The EMCC is fully DDA compliant
and there is good disabled access
throughout.

If you need to find Steering Committee
or Monitors while you are at AGM – they
are located on the landing above the
Atrium in Gallery Room 2 or Gallery 1
respectively, both will be signposted.

For those of you attending remotely,
Steering Committee and Monitors can
be accessed via email.



Steering

steering@napo.org.uk



Monitors

monitors@napo.org.uk

Getting here

The East Midlands Conference Centre (EMCC) is located in the grounds of Nottingham University (See Map).

By road

Leave the M1 motorway at Junction 25 to join the A52 to Nottingham. Follow the A52 for approximately 4 miles, at the Toby Carvery roundabout turn right onto the A6464 then turn left at the next roundabout to enter the University's West Entrance. There is ample free parking at the EMCC with two large car parks. If using the parking facilities please make sure you are in the EMCC car parks as if you park anywhere else you WILL need to display a parking permit on the Thursday or Friday (up to 4pm) otherwise will be ticketed by the University patrol teams.

By train

The nearest train stations are located in Nottingham City Centre or Beeston. Trams, taxis and buses are available at both stations.

The Tram

The easiest public transport link to University Park Campus from Nottingham is the tram line. This is accessible by a walkway leading from Nottingham train station. Tickets must be purchased before boarding. Make sure you take the Toton line. This will take you directly to the University. Disembark at the University of Nottingham Stop. Trams are frequent and the journey takes around 10-15 minutes. A timetable can be found at <http://www.thetram.net/maps-times.aspx>

By plane

The nearest airport is the East Midlands Airport. From there you can take the Trent Barton Indigo service directly to the campus or the Skylink bus to Nottingham. Buses leave from outside the Airport Arrivals hall.

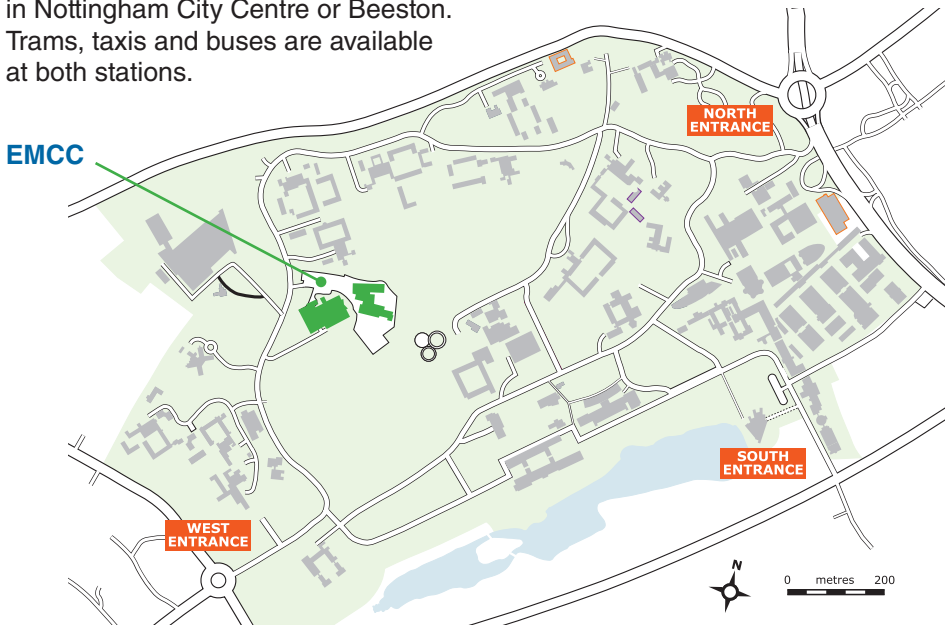

Getting around the EMCC

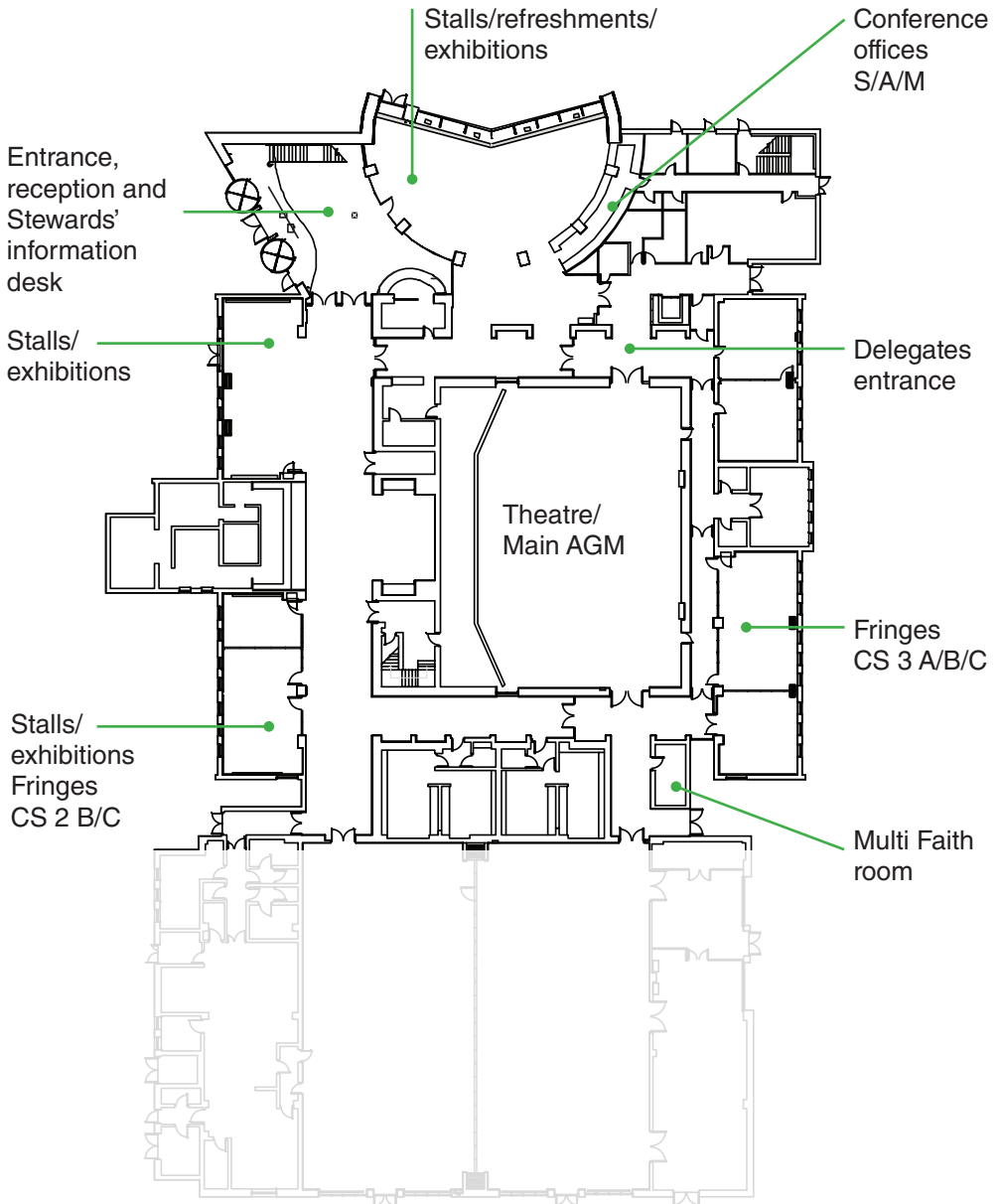

Napo AGM 2023

Conference Documents

The documents you will receive in your conference pack on arrival at AGM will include:

- The minutes of the 2022 AGM
- The draft Annual Report and Accounts 2022/2023
- Standing Orders
- Finance Report
- The notice of proposed motions for AGM
- Composite motions (if any)
- Amendments (if any)
- The Order of Motions/Business

The full Constitution will not be printed. It is available online (along with all the above documents). If you do require a paper copy however please email **events@napo.org.uk** and we will make one available to you.

All documents will be posted as available at **<https://www.napo.org.uk/agm>**



If you need to contact the AGM Organising Team at any time (and can't find them at Napo Reception) email **events@napo.org.uk**

Programme

Thursday 19 October

14.00 Conference Opens

14.00 – 15.00 Chairs Address
Formal Business including:

- Minutes of 2022 meeting
- Election of Officers
- Finance Report
- Edridge Report

15.00 – 15.30 Speaker: **Kim Thornden-Edwards**, Chief Probation Officer, HMPPS

15.30 – 16.00 Break

16.00 – 16.20 Speakers: **Liz Saville-Roberts MP** and **Lord Fred Ponsonby**, Co-Chairs of the Justice Unions Parliamentary Group (JUPG)

16.20 – 17.45 Motions

18.00 – 19.00 Fringe meetings

Thanks to our
main sponsor



Friday 20 October

9.30 – 10.45	General Secretary's Address Accountability Session Changeover of Officers
10.45 – 11.00	Speaker: Paul Nowak , General Secretary, Trades Union Congress (TUC)
11.00 – 11.30	Break
11.30 – 13.00	Professional Session 'When workloads become a risk' Speakers: <ul style="list-style-type: none">• Samantha Ainslie, Senior Lecturer Criminology and Criminal Justice, Sheffield Hallam University• Simi O'Neill, HMIP Head of Probation Programme• Becky Shepherd, Senior Lecturer Criminology, London South Bank University• Nicki Kenney, Napo Health & Safety Network
13.00 – 14.15	LUNCH
13.00 – 14.15	Fringe meetings
14.15 – 14.30	Speaker: Steve Gillan, General Secretary, POA
14.30 – 13.30	Motions
15.30 – 16.00	Break
16.00 – 17.45	Motions
18.00 – 19.00	Fringe meetings

Saturday 21 October

9.30 – 10.45	Motions
10.45 – 11.00	TBC – speaker: "When we worked at Raleigh"
11.00 – 11.30	Break
11.30 – 13.00	Motions & Close of Conference

AGM Fringe

Thursday evening

18.00 – 19.00

Conference Suite 3A

Napo Black Network meeting – an ongoing evaluation of Napo's Anti-Racism Action Plan

Conference Suite 3C

Women working with women – this is a follow up session from online training events we have held with Becky Shepherd, Senior Lecturer Criminology, London South Bank University, around Vicarious Trauma.

Friday lunchtime

13.00 – 14.15

Conference Suite 3A

Napo LGBT+ Network meeting

Conference Suite 3C

Desistance – Samantha Ainslie, Senior Lecturer Criminology and Criminal Justice, Sheffield Hallam University talks about her research around this.

Friday evening

18.00 – 19.00

Conference Suite 3A

Napo Disabled Members' Network meeting – this session is to look at what peoples' unmet needs are and to explore what themes are emerging within Branches about the difficulties neurodiverse staff experience.

Conference Suite 3B

Napo Young Members' Network meeting. How can we attract 'the next generation' into Napo?

Conference Suite 3C

Probation work – the politics of professional identity. Anne Burrell is researching professional identity in probation practice – how it is constructed, and what it means to probation practitioners.

What factors motivate probation workers to do the job; what sustains you in your role, and what do you find constrains you from doing your job effectively?

There is a multi-faith room by Conference Suite 3a which is available throughout conference and will be sign-posted and as per map provided in the programme.

A range of stalls can be found in Conference Suite 1, the Atrium and Conference Suite 2. Again, all this will be sign-posted.